

Cabinet Construction

Heavy duty stainless steel interior and exterior, and galvanized steel finished top, bottom and back wall of exterior. ABS evaporator drain cover. 2.5" thick high density foamed-in-place polyurethane insulation. Four 4" diameter casters (front casters with brakes). Door heater installation around inside cabinet frame to prevent moisture build-up.

Refrigeration System

- Self-contained condensing unit located at top of cabinet for high performance
- Oversized condenser and evaporator coil cools to set and maintain temperature in minimum time period
- Forced-air cooling with dual evaporator fan motors providing balanced airflow throughout cabinet to ensure faster temperature drop
- Environmentally friendly CFC free R-134A refrigerant
- Adjustable, time initiated defrost cycle of 3 to 12 hours with 350 watt heater, both time and temperature terminated for fail-safe backup
- Automatic evaporator fan motor delay on defrost cycle
- Copper tube and aluminum fan evaporator with anti-corrosive coating
- Energy efficient condensate drain pan located at bottom of cabinet constructed of anodized aluminum
- Two pressure relief ports located at exterior back wall and top of cabinet for rapid re-entry
- Interior airflow back guard to ensure proper air circulation
- Pre-wired and ready to plug, 115V/60Hz/1Ph, NEMA 5-15P

Doors

- Heavy duty stainless steel interior and exterior
- 2.5" thick high density foamed-in-place polyurethane insulation
- Rounded corners for a sleek and modern appearance
- Heavy duty adjustable torsion spring self-closing door system
- One piece snap-in magnetic door gasket for easy replacement
- Heavy duty recessed door handles for a fat surface
- Door locks
- Field reversible doors (*available from 2013 models*)

Lighting

- Safety shielded incandescent interior lighting

Shelving

- Three epoxy coated wire shelves per section
- Stainless steel pilasters and shelf clips

Temperature Control

- Factory preset temperature, 35°F
- Temperature setting range from 33°F to 41°F
- Easy to read digital temperature display
- Easy to program push button temperature control
- Microchip digital monitoring system with a variety of functions to monitor and maintain optimum temperature



TSR1



TSRH2



TSR2



TSWR2



TSR3

Dimensions

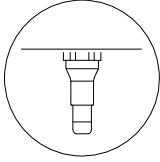

Two additional front adjustable stainless steel clad ABS legs for model TSR1 and TSRH2 to prevent movement of unit when opening and closing doors, and one additional leg for model TSR3 to support weight in the middle

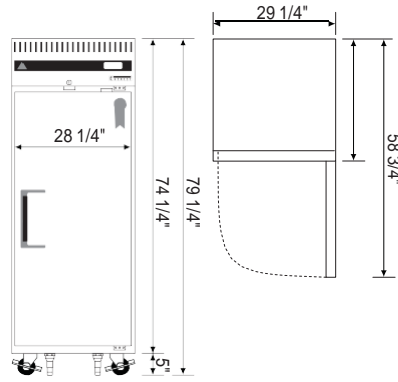

▲ TSR1

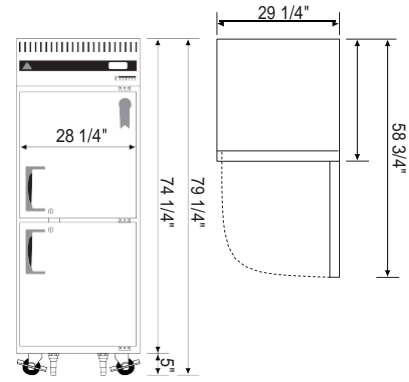

▲ TSRH2

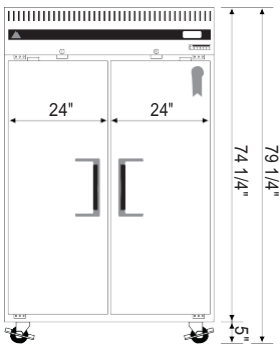
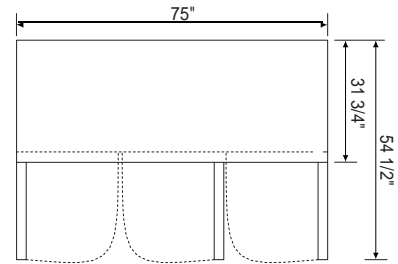
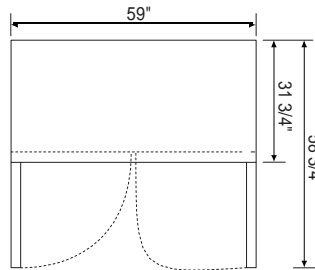
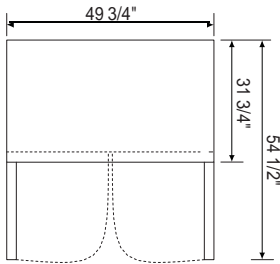

▲ TSR2

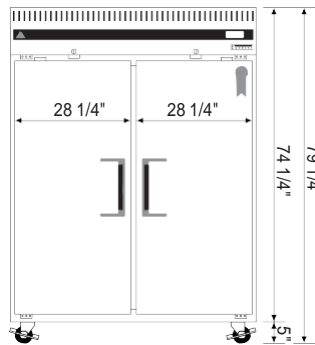

▲ TSWR2

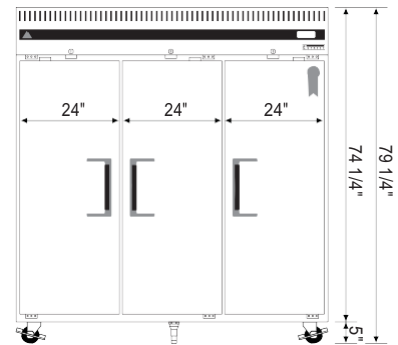

▲ TSR3

Model	Ref/ Fzr/ Dual	# of Doors	Capacity (Cu.Ft.)	HP	Refrigerant	# of Shelves	Power (V- Hz-Ph)	Amps	Crated Weight (LBS)	Exterior Dimensions (Inches)			Height does not include 5" for caster. Ref = Refrigerator Fzr = Freezer Dual = Ref & Fzr Combo H = Half Door
										L	D	H	
TSR1	Ref	1	23	1/3	R-134A	3	115-60-1	4.70	284	29 1/4	31 3/4	74 1/4	
TSRH2	Ref	2(H)	23	1/3	R-134A	3	115-60-1	4.70	289	29 1/4	31 3/4	74 1/4	
TSR2	Ref	2	48	1/3	R-134A	6	115-60-1	5.06	384	49 3/4	31 3/4	74 1/4	
TSWR2	Ref	2	55	1/3	R-134A	6	115-60-1	5.06	421	59	31 3/4	74 1/4	
TSR3	Ref	3	71	1/3 x 2	R-134A	9	115-60-1	9.49	595	75	31 3/4	74 1/4	