



RM-65-HC

Glass Door Merchandiser with Swing Door



RM-65-HC
08/04/23
Item # 13463

W x D x H

78" x 29.75" x 78"



Item #: _____
 Project: _____
 Qty: _____
 AIA#: _____

Features

- ▶ Curved vertical corners with silver aluminum exterior provide enhanced product display
- ▶ Forced air evaporator for quick temperature pull down
- ▶ Energy saving hot gas loop on front edge of cabinet helps prevent condensation



• Listed under NSF/ANSI Standard 7 for the storage and/or display of packaged or bottled products.

• Large glass doors are energy efficient Low-E multi pane glass with locks

• Doors are standard with locks

• (5) white epoxy coated shelves per section with product stops are standard

• LED illuminated exterior graphic display

• Energy efficient vertical LED interior lights illuminate products on display

• Door is mounted on heavy duty hinges with self-closing mechanism

• Silver painted aluminum exterior with NSF approved white steel interior and stainless steel floor

• Time initiated automatic defrost

• Environmentally friendly CFC-Free Polyurethane insulation with cyclopentane blowing agent.

• Stainless steel shelf clips adjustable in 1/2" increments on anodized aluminum supports

• Refrigerant flow is controlled with a capillary tube

• 8 Foot cord and plug

• 2 inch leveling legs standard

Capacity:

20 oz. bottles: 830

12 oz. bottles: 1926

Container Qty: 14

If GFCI is required, a GFCI breaker MUST be used in lieu of GFCI receptacle

Hoshizaki reserves the right to change specifications without notice.

Dimensions / Capacity

Three Section RM-65-HC

Interior Storage Capacity (CF)	56.04 ft ³
Overall Width x Depth	78" x 29.75"
Height	78"
Depth with Door Open	53.25"
Adjustable Shelves	5 per section
Shelf Dimensions (W x D)	(Center) 27.3" x 21.7" / (L&R) 22.4" x 21.7"
Crated Shipping Weight	800 lbs.
Crated Length x Depth x Height	81" x 32.25" x 84"

Electrical / Refrigeration

Three Section RM-65-HC

Voltage	115/60/1
HACR Breaker	15.0 Amps
Electrical Connection (NEMA)	5-15P ⚡
Voltage Range	104-126
Ambient Temp. Range	60° to 86°F
Control Setpoint Range	28° to 40°F
Amperage	8.2
Energy Consumption (kWh/day) @ASHRAE	5.67
Approx. Nominal Compres. BTU/HR (HP)	(Left) 1217 (1/3HP) / (Right) 1217 (1/3HP)
Refrigerant / Charge Amount (oz)	R290/(4.10oz.) / R290/(4.10oz.)

Options

- Organizer shelf
- Price tag holder
- Epoxy Shelf

Requires 2 sets of:

- 4" Casters (HS-5288)

Warranty

3 Year - Parts and Labor on entire machine.
 5 Year - Parts on Compressor
 Valid in United States, Canada, Puerto Rico and U.S. Territories. Contact factory for warranty in other countries.



RM-65-HC

Glass Door Merchandiser with Swing Door

RM-65-HC
08/04/23
Item # 13463

FRONT VIEW

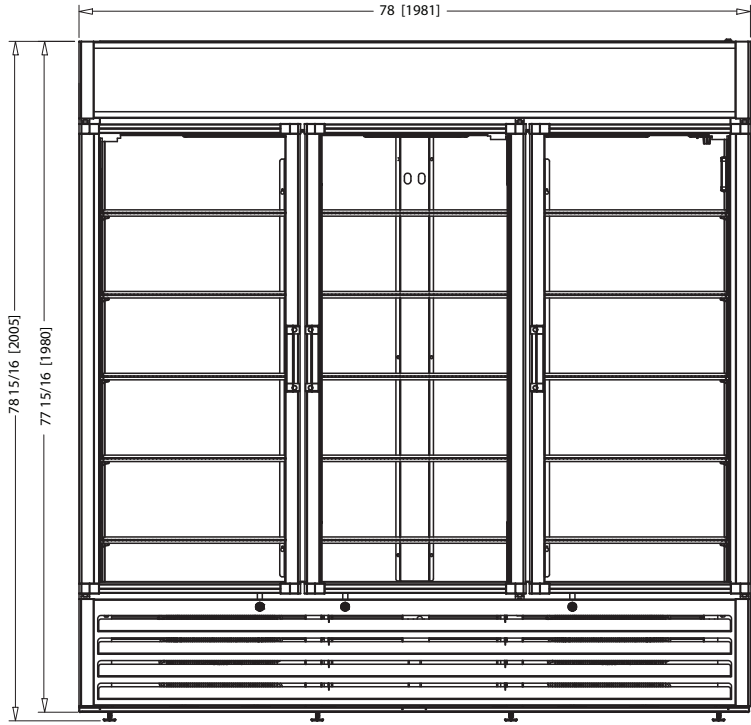

SIDE VIEW

inch [mm]

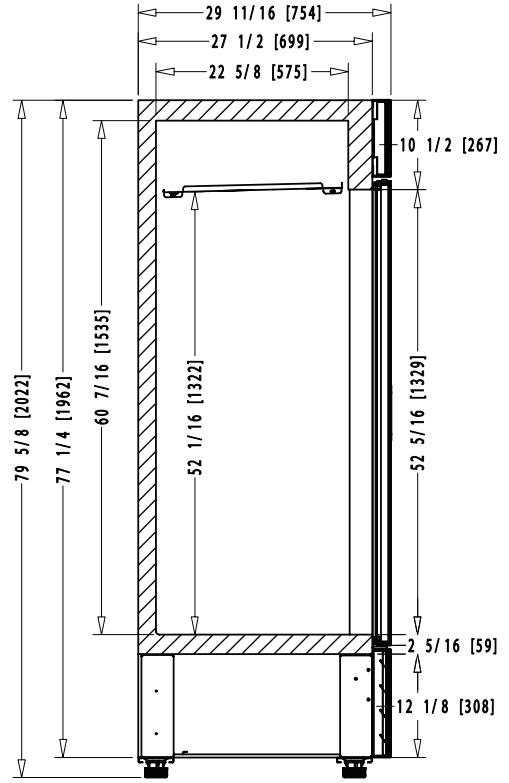

PLAN VIEW

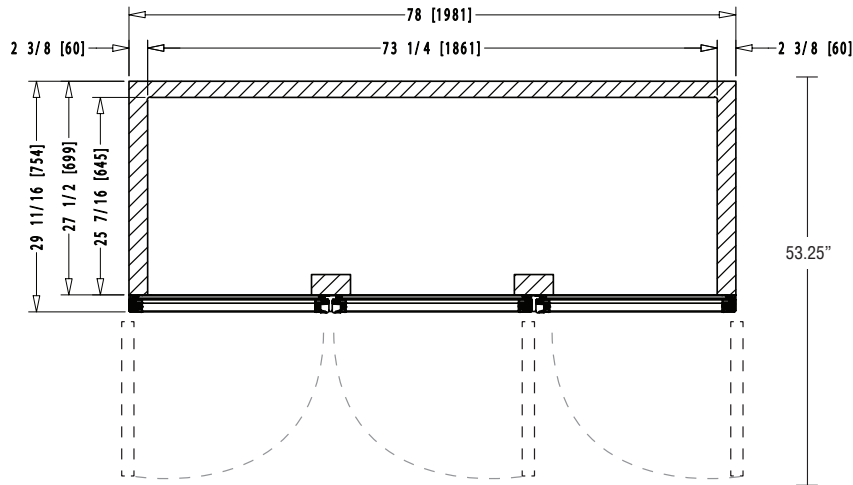

HEADER DIMS

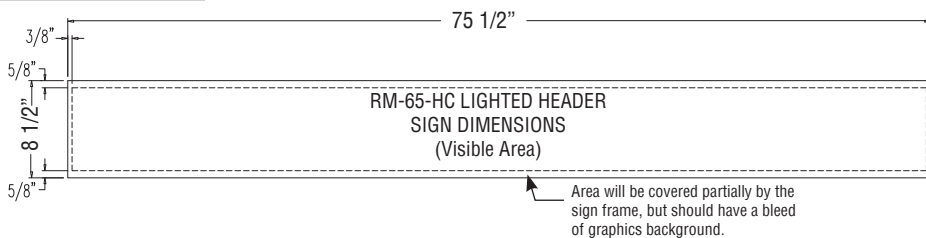

Note: Texts and important parts of the image should be within the visible area. The visible area is illustrated by dotted lines when it applies.

Graphic Requirements:

- 360 dpi resolution. Scale 1=1
- Graphics must be saved in photoshop (with layers) (or your sign company file type requirements)
- Colors for CMYK process
- Image with 1/4" of excess by side
- Include a full color print out

Material Requirements:

- Thickness: 1/16" (1.5mm)
- Good- Acrylic/Pexiglass, Better - high impact acrysteel, acrylite SG Best- Super impact Lexan, Lexan SG Polycarbonate