



Equipment for the Foodservice Industry

value + quality + service

## Back Bar Solid Door Coolers

CBBDR2-60CC



### CBBDR2-60CC

### Features

#### Features

- All steel construction with two exterior options
  - Exterior covered in an easy to maintain black vinyl
- Counter tops and interiors are made with Type 304 stainless steel
- Recessed handles
- Door equipped with locks for security
- Self-closing doors equipped to stay open when past 90 degrees
- Adjustable/removable plastic coated shelves

- Refrigeration system holds 33°F to 41°F (-0.5°C to 5°C) for optimum food preservation
- Removable door gasket
- Foamed-in polyurethane cell insulation
- Removable installation board makes it easy to access condenser coil for cleaning and service

#### Warranty

- 2 year parts and labour; 5 years on compressor
- Specifications subject to change without notice.



**CBBDR2-60CC Specifications**

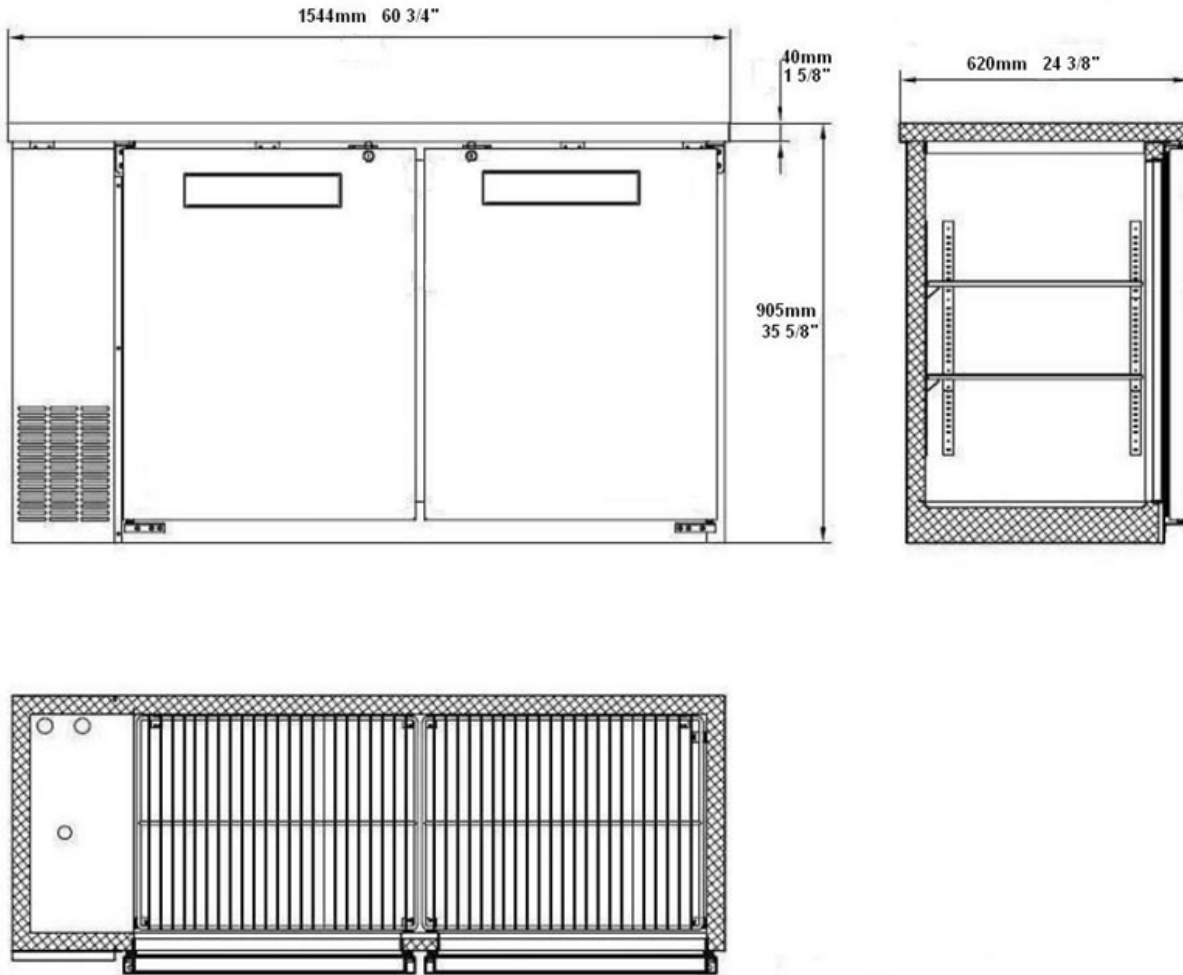

Model	Doors	Dimension (mm) (inch)			HP	Voltage	Amps	Capacity (L) (Cu Ft.)	Net Weight (KG) (LBS)	NEMA Config.
		L	D	H						
CBBDR2-60CC	2	1546.9	619.8	904.2	1/5	115/60/1	2.88	447.4	172.3	5-15P 
		60.9	24.4	35.6				15.8	380	